

16, Love Lane, Bexley DA5 1RJ  
Guide Price £575,000 - £600,000



Guide Price: £575,000 - £600,000

Beautifully presented, this three bedroom semi detached home sits just a short stroll from Old Bexley Village, placing you within easy reach of its charming selection of shops, restaurants and bars, as well as highly regarded primary, secondary and grammar schools. Bexley mainline station and excellent transport links are also close by, making this an ideal choice for families and commuters alike.

The property offers superb potential to extend (subject to the relevant planning permissions) and currently features a welcoming entrance hall, a bright reception room, and a modern fitted kitchen/dining room. Upstairs, you'll find three well proportioned bedrooms and a contemporary family bathroom.

Outside, the home enjoys landscaped front and rear gardens, off street parking, and a garage. Additional benefits include double glazing, gas central heating, and elegant hardwood herringbone flooring.

Early viewing is highly recommended to fully appreciate everything this excellent property has to offer.

Local Authority: Bexley

Council Tax Band: E



# 01322 553322

60-62 High Street, Bexley, Kent DA5 1AH

bexley@parkestates.co.uk  
www.parkestates.co.uk

## Love Lane

Approximate Gross Internal Area = 110.4 sq m / 1188 sq ft

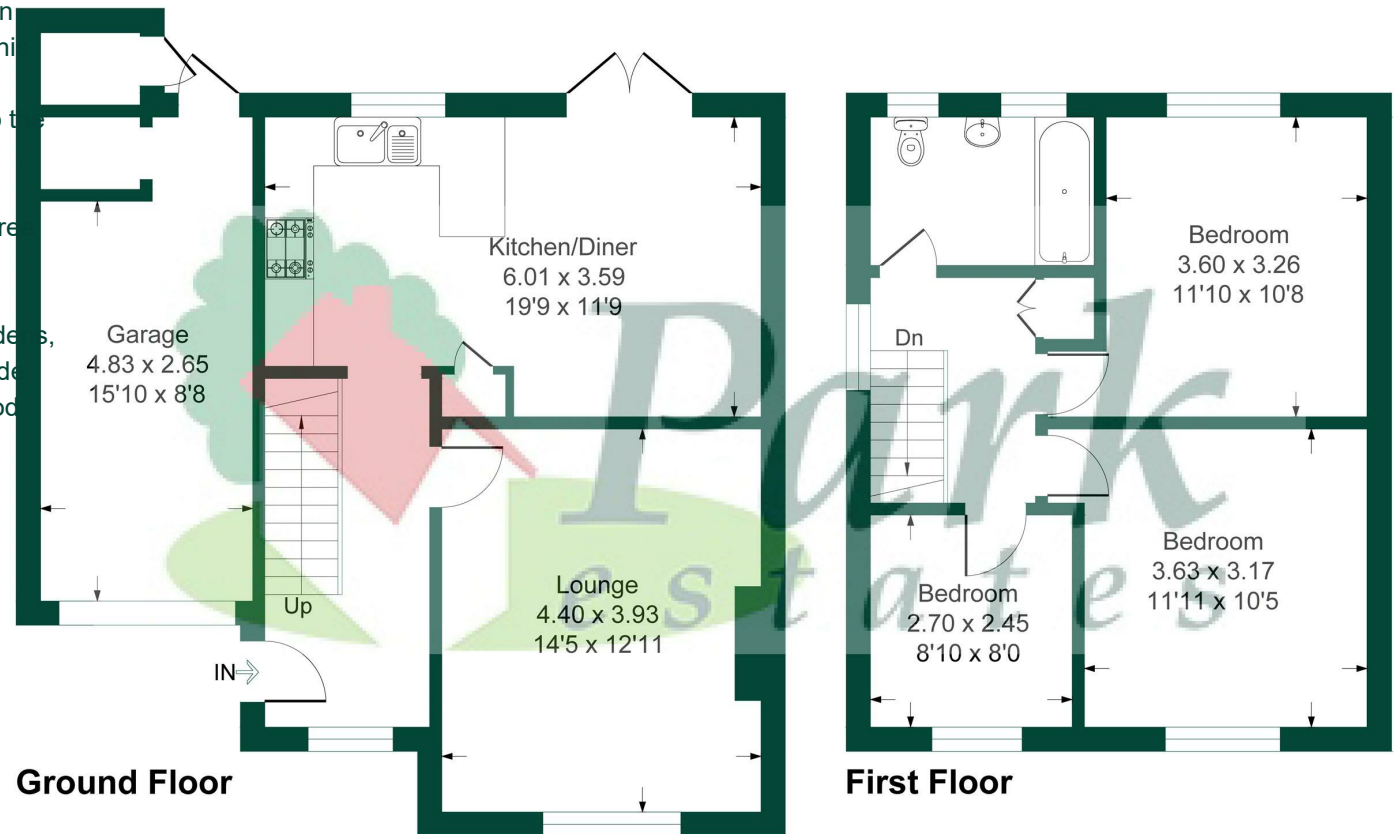

This plan is for layout guidance only. Not drawn to scale unless stated. Windows and door openings are approximate. Whilst every care is taken in the preparation of this plan, please check all dimensions, shapes and compass bearings before making any decisions reliant upon them.  
Produced By Planpix

Every care has been taken with the preparation of details, but accuracy is in no way guaranteed. These particulars do not constitute a contract and are issued and accepted on the express understanding that all negotiations will be conducted through Park Estates. The seller does not make or give, nor do we or our employees have any authority to give a representation or warranty in relation to the property. Please contact this office before viewing the property. If there is any point which is of particular importance to you, we will be pleased to check the information for you and confirm that the property remains available. This is particularly important if you are contemplating travelling some distance to view the property. We would strongly recommend that all the information that we provide about the property is verified by yourself on inspection and also by your conveyancer, especially where statements have been made by us to the effect that the information provided by us has not been verified.